

Revision _____ Emission _____

no.	Issue	date

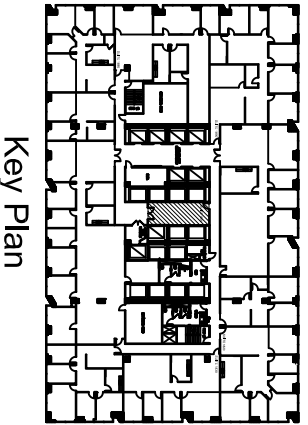
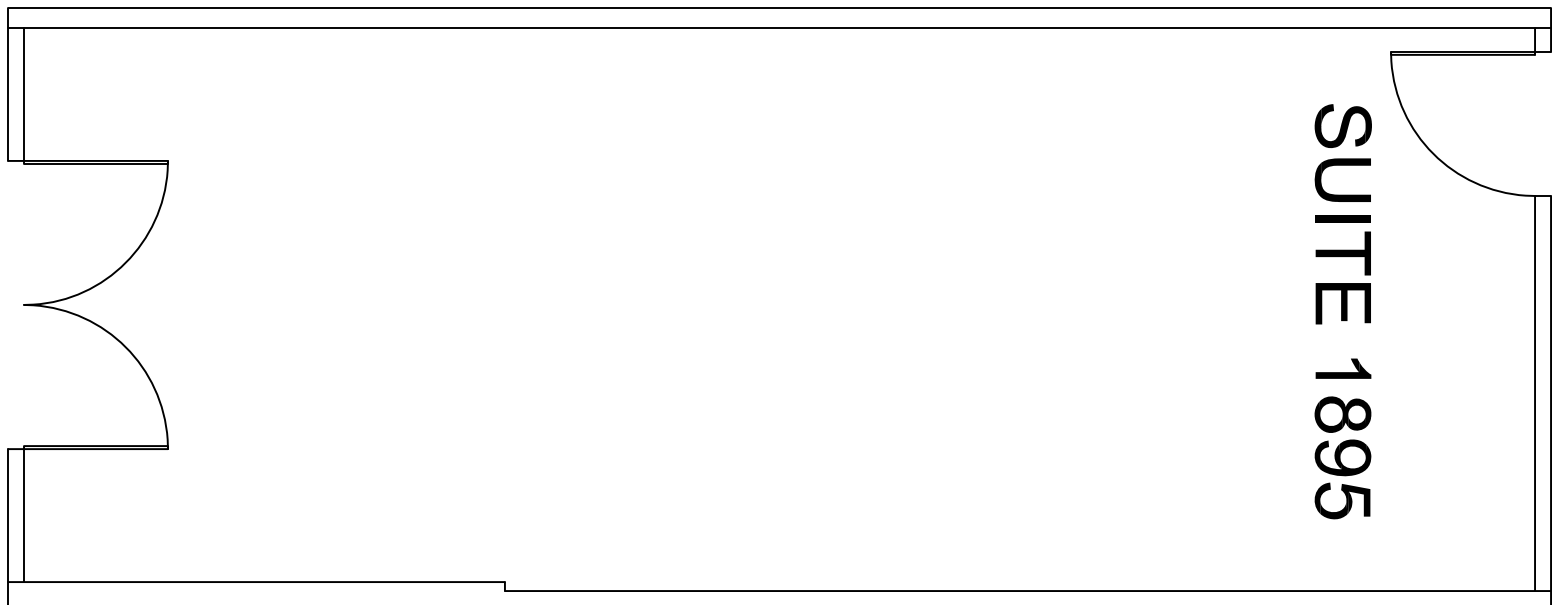

Key Plan

Title:
18th Floor Plan
Suite 1895



1700 PACIFIC
DALLAS, TX, 75201
TEL: 1-888-OLYMBEC
WWW.OLYMBEC.COM

Scale: N.T.S.
Drawn By: _____

Date: _____

Project Name and Location:
1700 Pacific
Dallas, TX

Room #:
#1895

I Suite 1895

SCALE: 1/4"=1'-0"
(11"X17")

SQUARE FOOTAGE IS APPROXIMATE
433 RSF

*Note That All Dimensions Are Approximate and subject to change without notice